

PERCAGES TRAVERSANTS LES DEUX PIECES

GENERAL TOLERANCES FOR MACHINED DIMENSIONS							
GENERAL TOLERANCES FOR LINEAR DIMENSIONS ISO 2768 FOLLOWING TABLE:							
DIMENSION (mm)	0-5	5-30	30-120	120-400	400-1000	1000-2000	2000
	±0.1	±0.2	±0.3	±1.2	±2	±3	±4
GENERAL TOLERANCES FOR RADII, CHAMFERS, ANGULAR DIMENSIONS							ISO 2768-m
GENERAL GEOMETRICAL TOLERANCES							ISO 2768-k
GENERAL SURFACE ROUGHNESS (ISO 1302)							

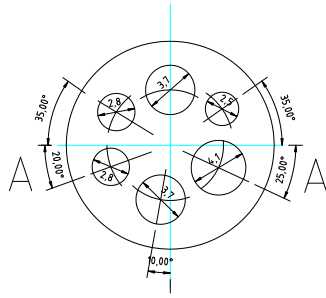

SECTION A-A

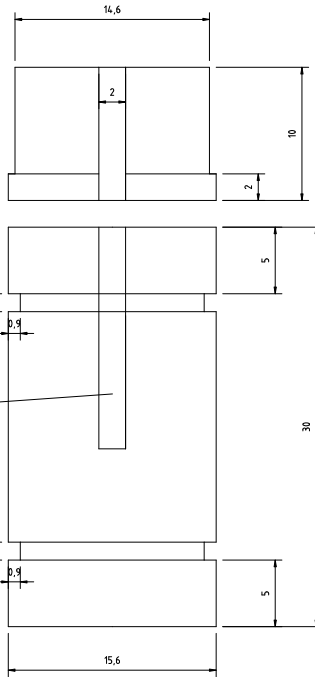

Percé taraudé en M2 sur 20mm de profondeur

Quantité 4
Matière PTFE

1	20-09-17	MV	AFC		
Rev.	Status	Date	Draw by	Revision Memo*	Check by Approv by

{Verdana,* Issued For Comments (IFC), Issued For Information (IFI), Issued For Review (IFR), Issued For Approval (IFA), Approved For }{Verdana;Construction (AFC)
* Preliminary offer (BID), As Built (ASB)

VALAT

7, rue de l'église Phone (+33) 7.61.94.40.66
30190 Saint-Genès-de-Malgoir*s FR*Email : mathieu@valat.eu

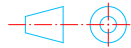

Scale : 2

TITLE :

Bouchons Staker

Dwg :

Rev. : 2

Client :

Job :

This document is the patents right of MATHIEU VALAT It cannot be communicate or copy without expicit written authorization.