

1 Moyer AC 1/2 DOR.

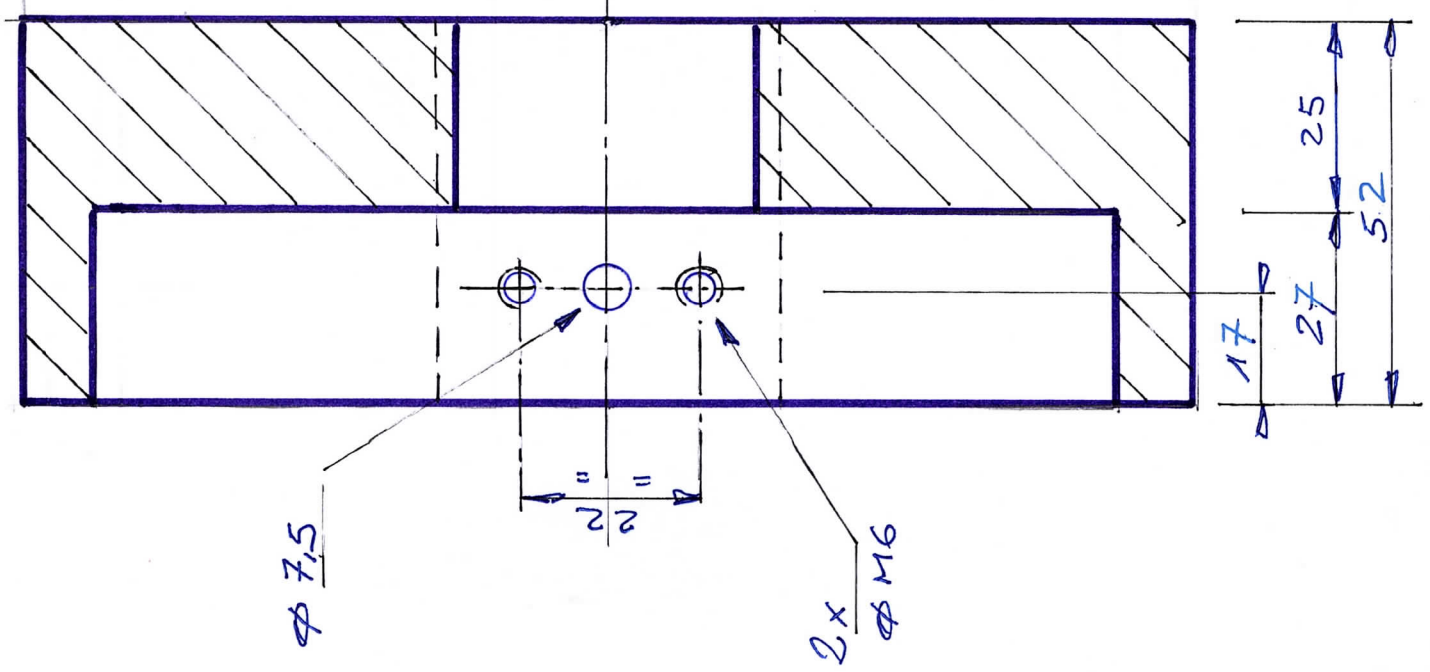

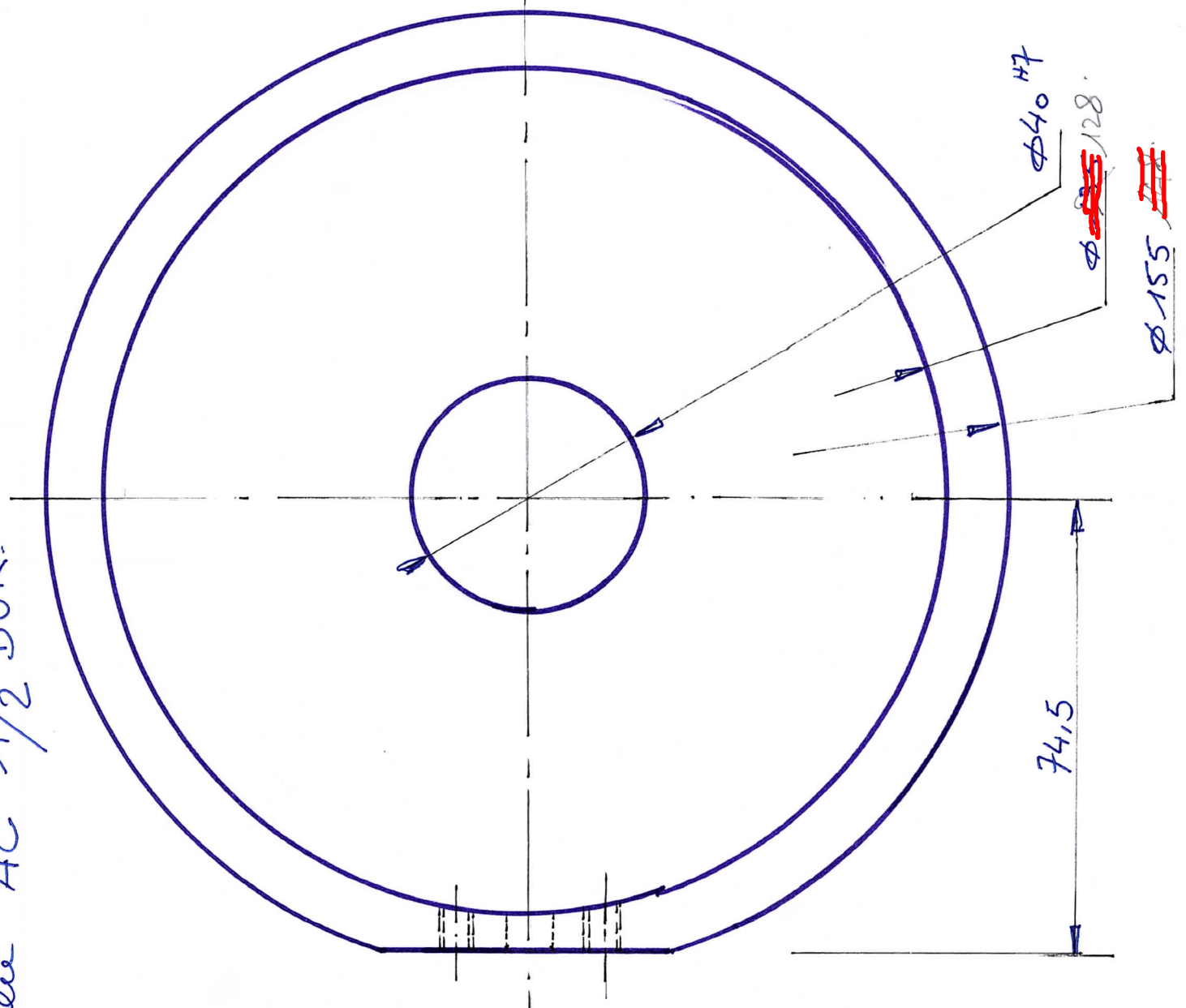

1 Doville AC 1/2 DUB

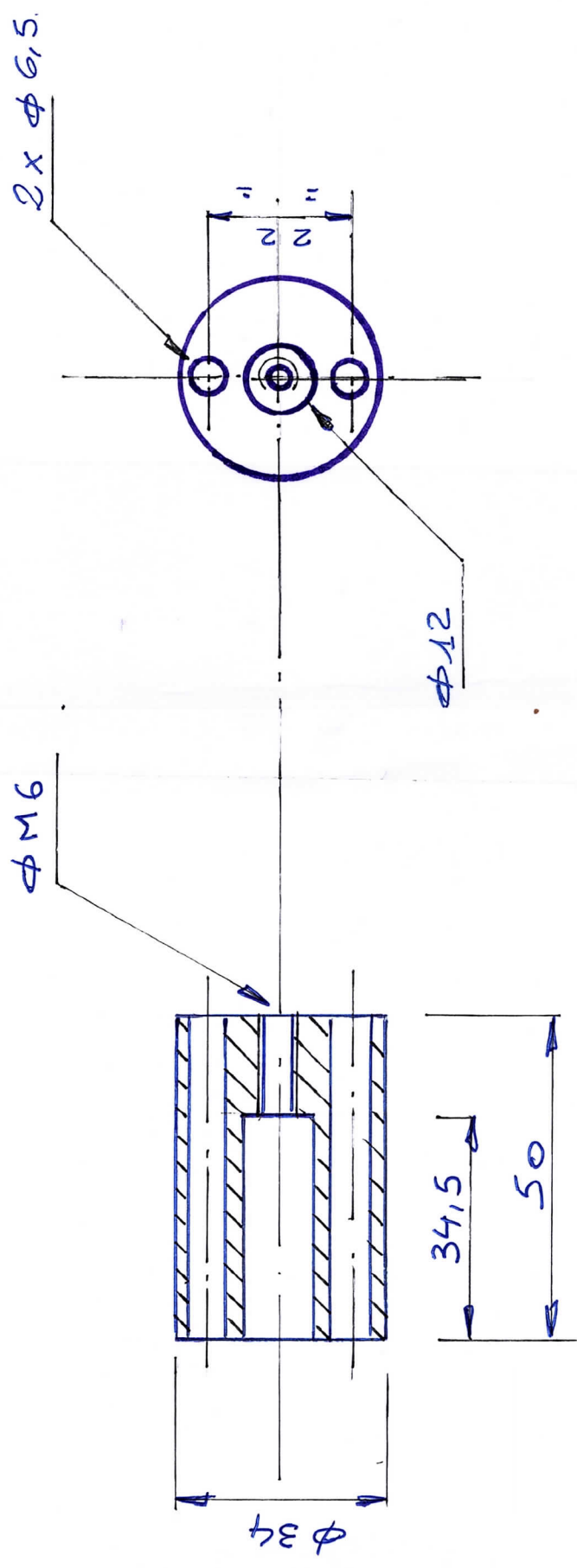
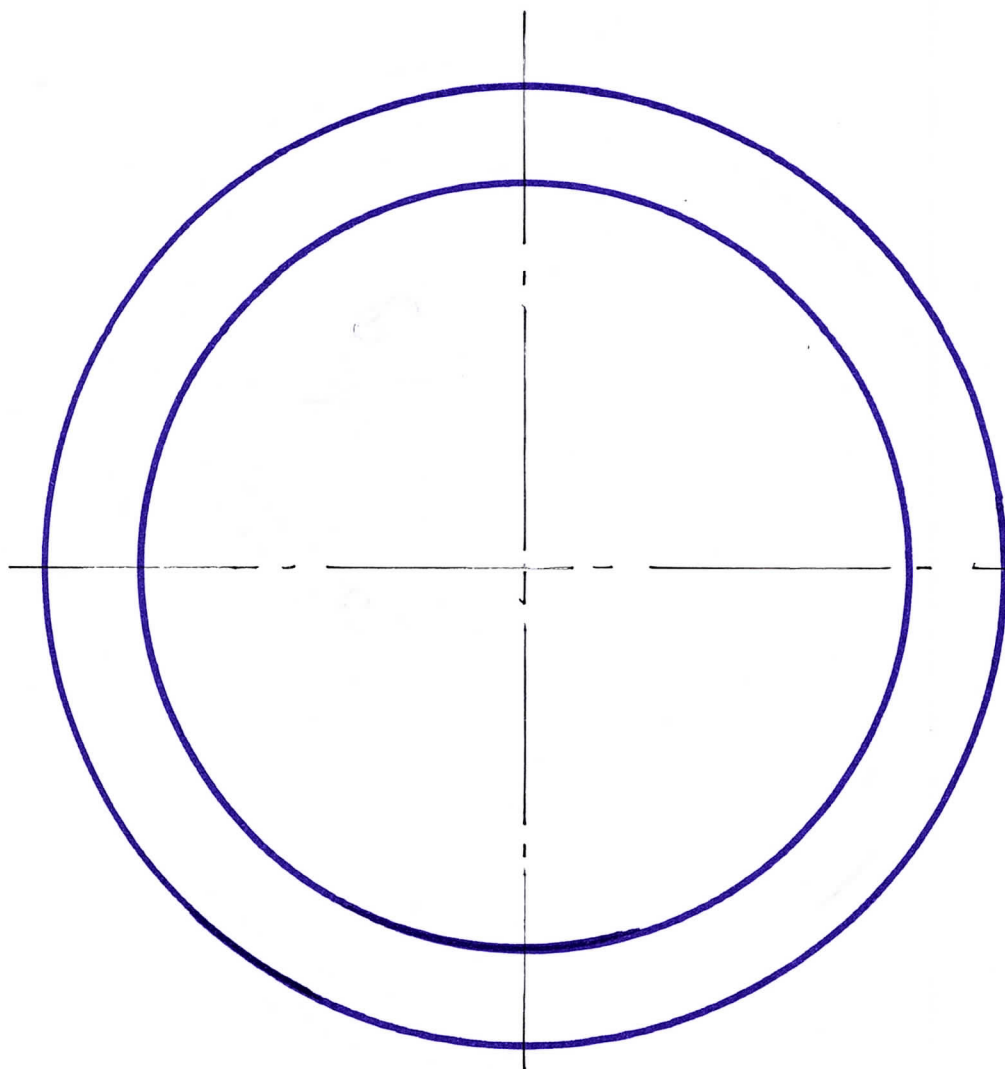
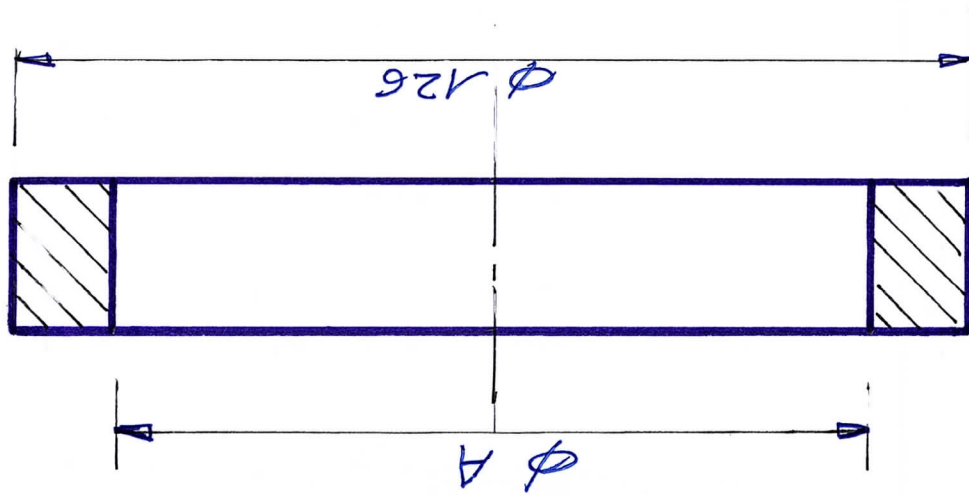

Matière ADX
ou AC 1/2 DOR

1 Piece A = 110 mm
1 Piece A = 99 mm

3x $\phi 6,8 \pm 120^\circ$
Sur $\phi 55$

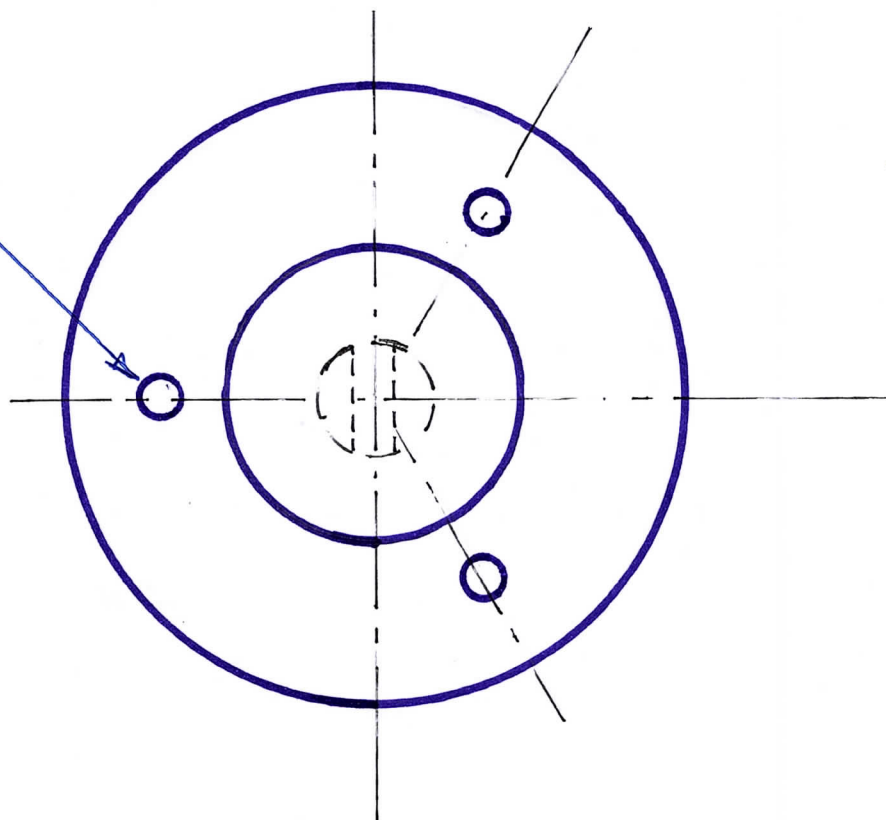

1 Flasque AC 1/2 DOR.

