

Technical drawing of a mechanical part with the following dimensions and features:

- Overall width: 30
- Overall height: 41.5
- Top chamfer:  $2 \times 4 \times 45^\circ$
- Bottom chamfer:  $2 \times 2 \times 45^\circ$
- Central hole diameter:  $\varnothing 5H8$
- Central hole depth: 16.5
- Bottom hole diameter:  $15.2^{+0.05}_{-0.15}$
- Bottom hole depth: 15.2
- Internal feature:  $2 \times R1$
- Feature A: Indicated by a box labeled 'A' and a leader line pointing to the top surface of the central hole.
- Feature B: Indicated by a box labeled 'B' and a leader line pointing to the bottom surface of the central hole.

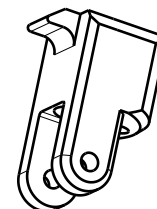

Echelle : 1/1  
Matiere : Aluminium  
Tol Generale : +/- 0.25  
Angles : +/- 1°  
Indice :05  
Date : 24/04/17