

E

E

D

D

C

C

B

B

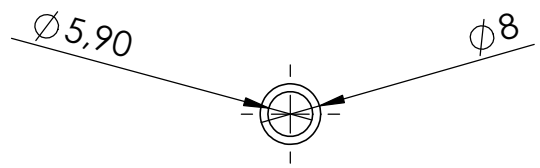
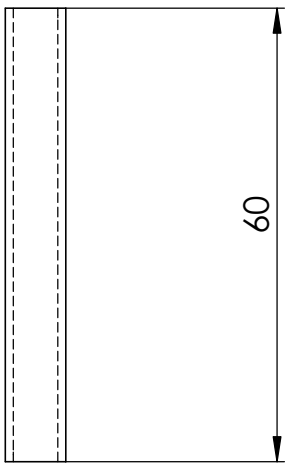

SAUF INDICATION CONTRAIRE: LES COTES SONT EN MILLIMETRES ETAT DE SURFACE: TOLERANCES: LINEAIRES: ANGULAIRES:	FINITION:			CASSER LES ANGLES VIFS	NE PAS CHANGER L'ECHELLE	REVISION

NOM	SIGNATURE	DATE		TITRE:
-----	-----------	------	--	--------